

# AUXILIARY POWER UNITS

## Very Compact & Powerful

Best known power to weight ratio with 10 kW diesel-genset

Space & weight saving up to 50% compared to benchmark

Only known APU with CAN-BUS interface SAE J1939



[www.suter-industries.com](http://www.suter-industries.com)

**Suter Industries AG**

Mettlenstrasse 3  
CH-8488 Turbenthal  
Phone: +41 52 397 10 60  
Mail: [info@suter-industries.ch](mailto:info@suter-industries.ch)

## Technical Data

Constant output	8.3 kw at sea level
Rated voltage & power	26-29 VDC 300 (320) A
Engine	Two-cylinder in-line OHV
Fuel Efficiency	1.8 l/h at 4 kW (primary fuel) 3.2 l/h at 8 kW (primary fuel)
Displacement	0.599 litre
Temp & Condition	-32... +49 °C air intake -32... +85 °C (+100) compartment
RPM	2900 – 3200 1/min
Noise level	80 dBA
Control & Interface	ECU / CAN-BUS SAE J1939
Electrical system	24 V and starter

## Dimensions

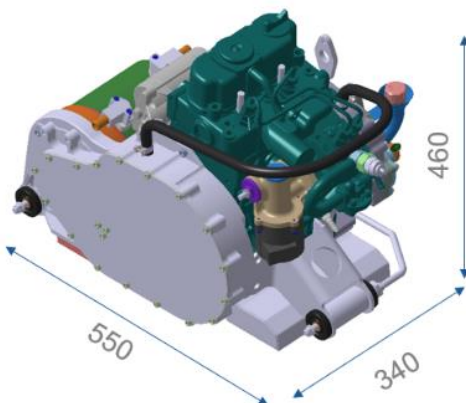

## Technical Features

Engine	<ul style="list-style-type: none"> <li>▶ Intake system naturally-aspirated</li> <li>▶ Connectors for external fuel tank</li> </ul>
Cooling	<ul style="list-style-type: none"> <li>▶ Internal cooling system including fan</li> <li>▶ DC generator water cooled</li> </ul>
Safety class	<ul style="list-style-type: none"> <li>▶ MIL-STD-461F, MIL-STD-810G</li> </ul>
Fuel	<ul style="list-style-type: none"> <li>▶ Diesel fuel EN 590</li> <li>▶ NATO F-54 (STANAG 1135 ED.4)</li> <li>▶ Alternative: F-34, F-35, F-44, F-63</li> </ul>
Weight	<ul style="list-style-type: none"> <li>▶ 140 kg</li> </ul>

## Platform & Possibilities

Integrated (vehicles):



Piggy-back:



Standalone:



Customized:

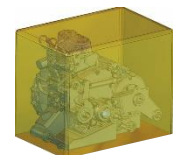

## Insight

