

004-74001-5 SuterClutch KTM 790/890

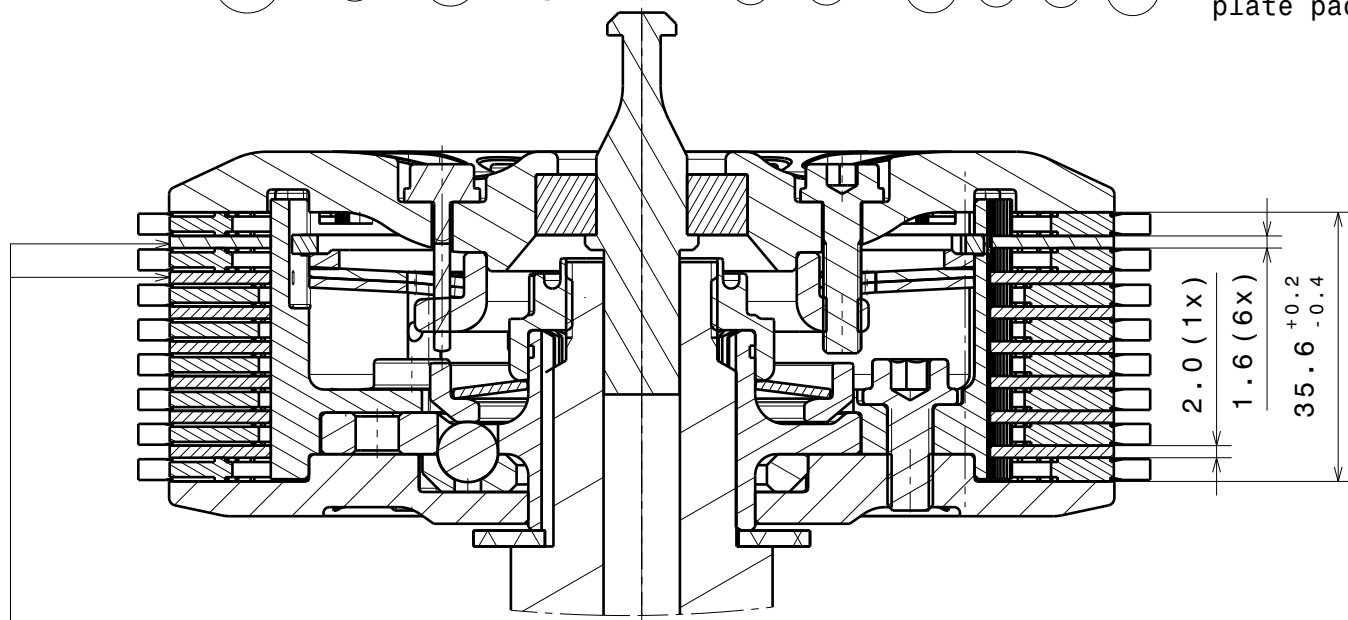
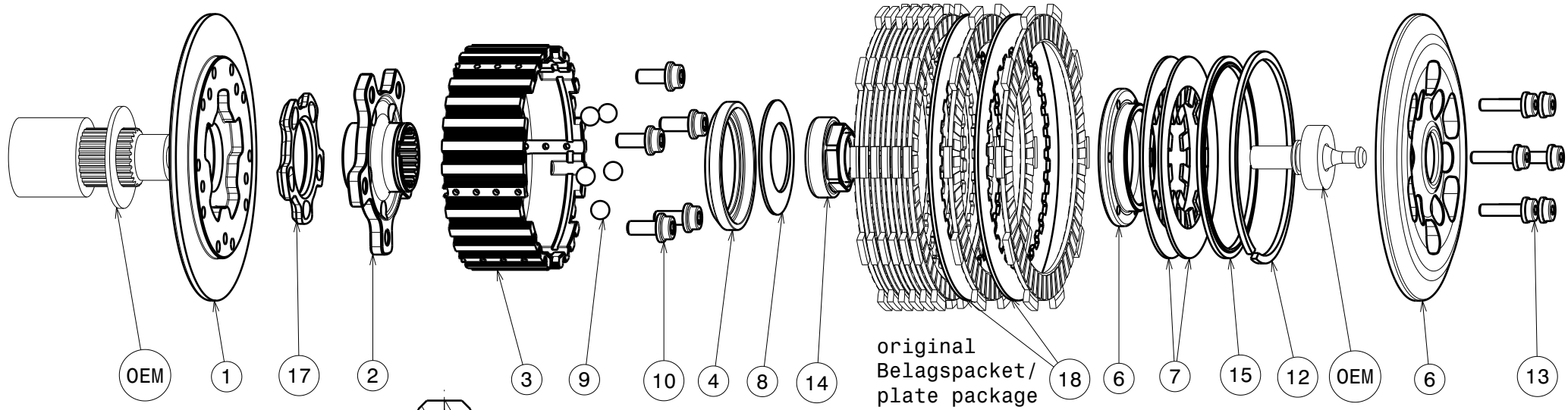

ITEM	PART NAME	SRT NUMBER	QTY
1	Back Plate	004-67721	1
2	Hub Carrier	004-74700	1
3	Inner Hub	004-74740	1
4	Release Ring	004-15975	1
5	Clamp Hub 6mm	004-00506	1
6	Pressure Plate	004-74941	1
7	Disk Spring Main ø88 800N	004-88080	2
8	Torque Limiter Spring 1100N	004-50110	1
8.1	Torque Limiter Spring 950N	004-50095	1
8.2	Torque Limiter Spring 1300N	004-50130	1
9	Ball 8mm	004-17801	5
10	Bolt M6x14	004-17814	5
12	Circlip 90mm	004-17804	1
13	Distance Bolt M5 L=20.0mm	004-05200	6
15	Locking Ring 88mm	004-00688	1
17	Ramp Insert 35°	004-00724	1
18	Steel Disk 1.6mm	004-67922	2
20	Main Nut M20x1.5 L=6.75	004-74950	1

Diese Stahlscheiben müssen durch die mitgelieferten (Pos.18) ersetzt werden
 These steel disks have to be replaced with the delivered ones (Pos.18)

Das angegebene Belagspaketmass ist zwingend einzuhalten!
The plate package thickness must be strictly adhered to!

Husqvarna	KTM				
901 Norden	790 Duke	790 Adventure Adventure R	890 Duke R	890 Adventure Adventure R	890 RC8C
2022	2018	2019	2020	2021	2020
-	-	-	-	-	-
2023	2020	2020	2023	2023	2023