

004-73002-0 SuterClutch BMW

R1200GS

R1250GS

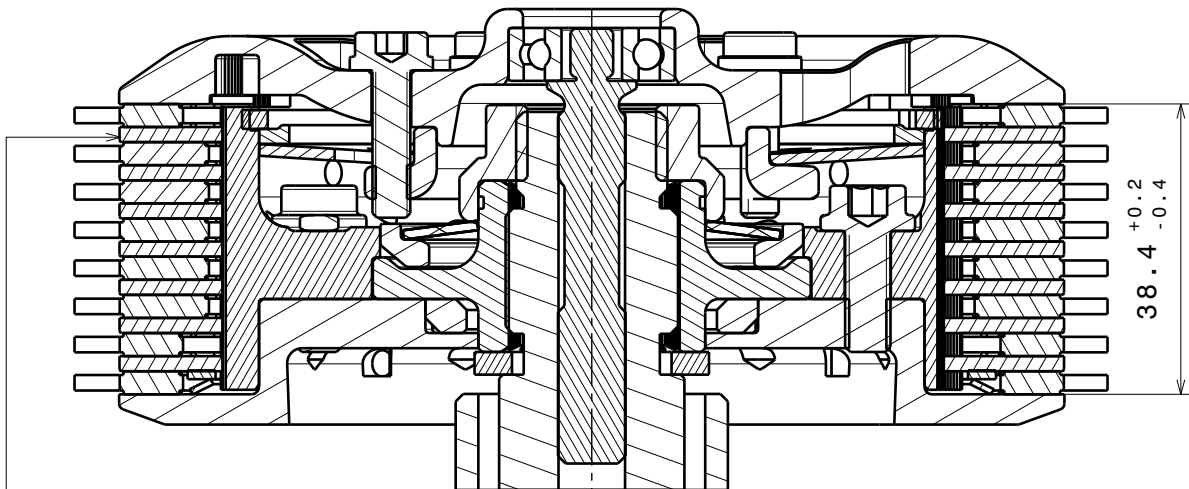
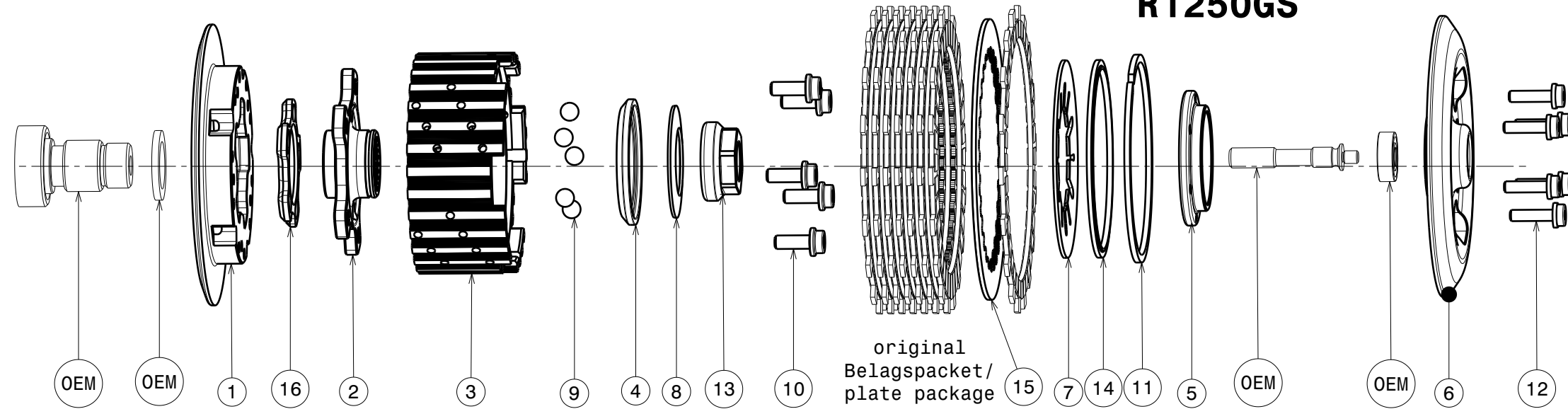

Diese Stahlscheibe muss durch die mitgelieferte (Pos.15) ersetzt werden
 This steel disk has to be replaced with the delivered one (Pos.15)

Das angegebene Belagspaketmass ist zwingend einzuhalten!
The plate package thickness must be strictly adhered to!

Partlist: 2658

ITEM	PART NAME	SRT NUMBER	QTY
1	Back Plate	004-73720	1
2	Hub Carrier	004-73700	1
3	Inner Hub	004-73741	1
4	Release Ring	004-09975	1
5	Clamp Hub 5mm	004-00505	1
6	Pressure Plate BMW	004-73941	1
7	Disk Spring Main ø88 1310N	004-88131	1
8	Torque Limiter Spring 850N	004-50085	1
	Torque Limiter Spring 750N	004-50075	(1)
	Torque Limiter Spring 950N	004-50095	(1)
9	Ball 8mm	004-17801	5
10	Bolt M6x16	004-17816	5
11	Circlip 90mm	004-17804	1
12	Distance Bolt M5 L=19.5mm	004-05195	6
13	Nut M20x1.5 L=5.5	004-999201555	1
14	Locking Ring 88mm	004-00688	1
15	Steel Disk	004-67921	1
16	Ramp Insert 35° 4.5 CW	004-00764	1