

004-68001-0 SuterClutch KTM 250/390

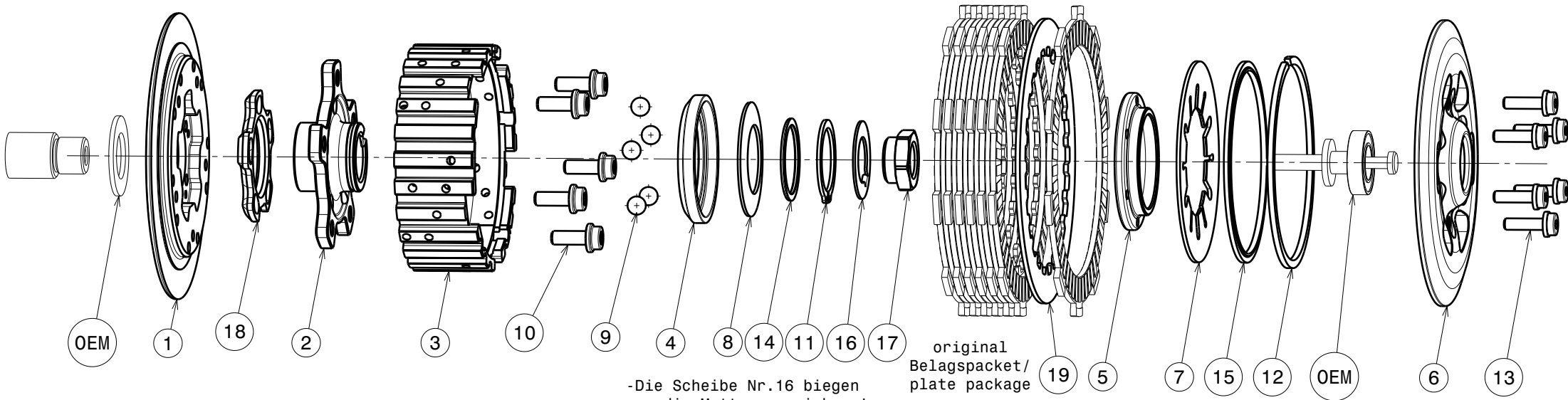

-Die Scheibe Nr.16 biegen um die Mutter zu sichern!
 -Bend the washer No.16 to lock the nut!

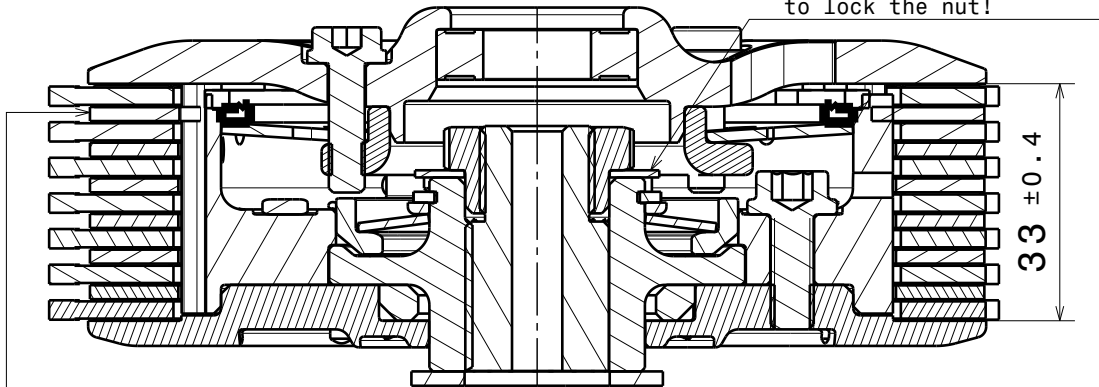

Diese Stahlscheibe muss durch die mitgelieferte (Pos.19) ersetzt werden
 This steel disk has to be replaced with the delivered one (Pos.19)

Das angegebene Belagspaketmass ist zwingend einzuhalten!
The plate package thickness must be strictly adhered to!

| Husqvarna | | KTM | | | | |
|-----------------|-------------------|-------------|-----------|------------------|-------------|-----------|
| 401 VITPILEN | 401 SVARTPILEN | 250 Duke | RC 250 | 390 Adventure | 390 Duke | RC 390 |
| 2018 | | | | 2015 | | 2016 |
| - | | | | - | | - |
| 2023 | | | | 2023 | | 2023 |

| ITEM | PART NAME | SRT NUMBER | QTY |
|------|-----------------------------|---------------|-----|
| 1 | Back Plate | 004-14721 | 1 |
| 2 | Hub Carrier | 004-68700 | 1 |
| 3 | Inner hub | 004-68740 | 1 |
| 4 | Release Ring | 004-15975 | 1 |
| 5 | Clamp Hub 5mm | 004-00505 | 1 |
| 6 | Pressure Plate | 004-68940 | 1 |
| 7 | Disk Spring Main ø88 1310N | 004-88131 | 1 |
| 8 | Torque Limiter Spring 950N | 004-50095 | 1 |
| | Torque Limiter Spring 850N | 004-50085 | 1 |
| | Torque Limiter Spring 1100N | 004-50110 | 1 |
| 9 | Ball 8mm | 004-17801 | 5 |
| 10 | Bolt M6x16 | 004-17816 | 5 |
| 11 | Circlip 30mm | 004-00030 | 1 |
| 12 | Circlip 90mm | 004-17804 | 1 |
| 13 | Distance Bolt M5 L=18.0mm | 004-05180 | 6 |
| 14 | Distance Ring 30x36x1.6 | 004-997303616 | 1 |
| 15 | Locking Ring 88mm | 004-00688 | 1 |
| 16 | Locking Washer 20/34 | 004-00670 | 1 |
| 17 | Nut M16x1.5-LH | 004-68955 | 1 |
| 18 | Ramp Insert 30° | 004-00722 | 1 |
| 19 | Steel Disk RC390 | 004-9966810 | 1 |