

004-55005-9 SuterClutch 2016-2023

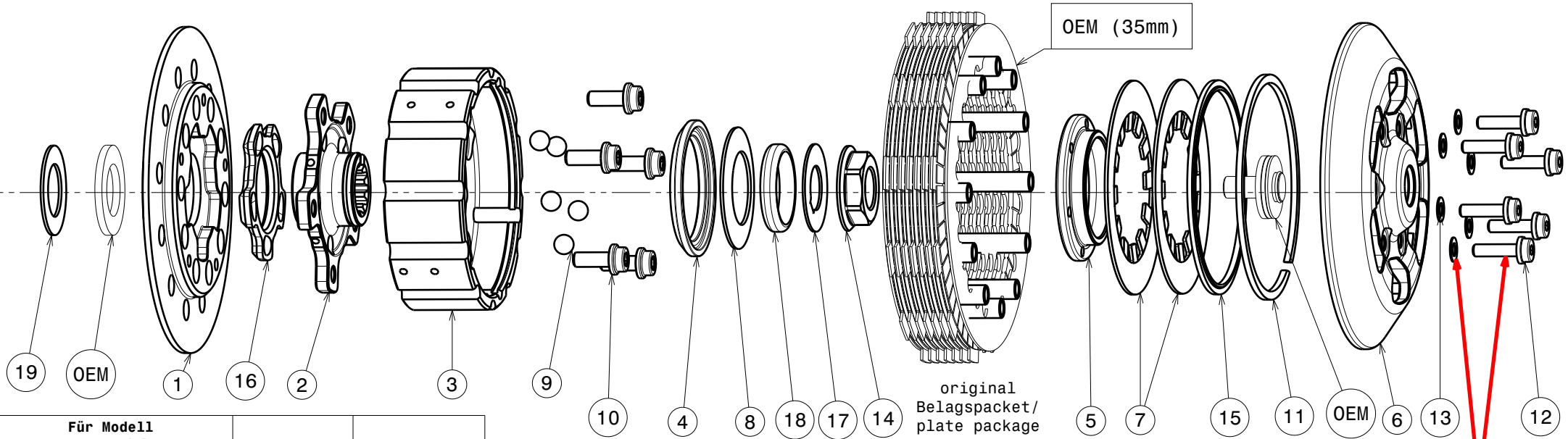

Für Modell For Model			Thrust Washer
GasGas	KTM/Husqvarna	KTM Factory	OEM Washer
2020 - 2023	2016 - 2022	2016 - 2021	Pos.19
	2023	2022 - 2023	

In jedem Einbaufall: nur **eine** Scheibe verwenden!
In any case: use only **one** of the 2 washers!

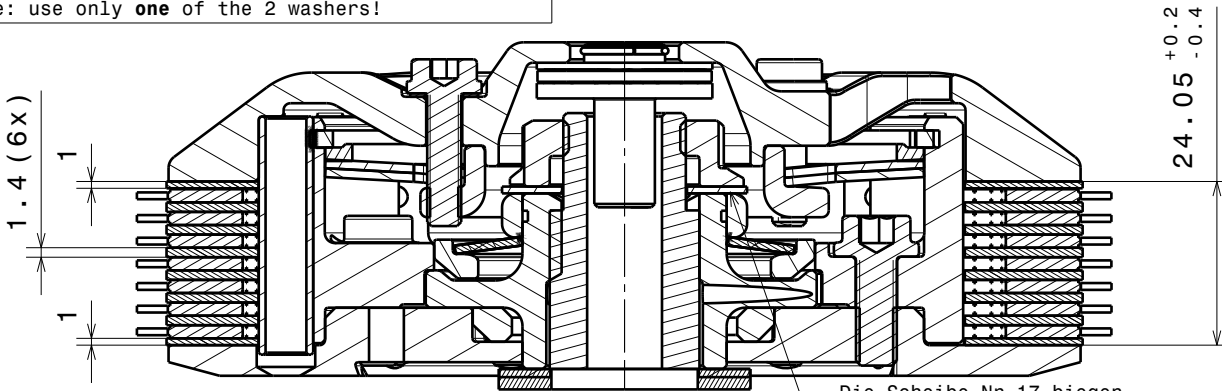

-Die Scheibe Nr.17 biegen um die Mutter zu sichern!
-Bend the washer No.17 to lock the nut!

Das angegebene Paketmass ist zwingend einzuhalten!
The plate package thickness must be strictly adhered to!

Partlist: 1888			
ITEM	PART NAME	SRT NUMBER	QTY
1	Back Plate Insert	004-55727	1
2	Hub Carrier	004-55702	1
3	Inner Hub	004-55743	1
4	Release Ring	004-09975	1
5	Clamp Hub 6mm	004-00506	1
6	Pressure Plate	004-55943	1
7	Disk Spring Main ø88 700N	004-88070	2
8	Torque Limiter Spring 1100N	004-50110	1
	Torque Limiter Spring 950N	004-50095	1
9	Ball 8mm	004-17801	5
10	Bolt M6x16	004-17816	5
11	Circlip 90mm	004-17804	1
12	Distance Bolt M5 L=19.5mm	004-05195	6
13	Distance Washer 0.2mm	004-00002	6
14	Main Nut M18x1.5	004-55958	1
15	Locking Ring 88mm	004-00688	1
16	Ramp Insert 27.5°	004-00721	1
17	Locking Washer 18/36/1	004-55671	1
18	Distance Ring 6.5mm	004-55610	1
19	Thrust Washer 1.2mm	004-55901	1

GasGas			Husqvarna		KTM	
125 MC	MC250F	MC350F	250 FC	350 FC/FX	250 SX-F	350 SX-F
2020 - 2023			2016 - 2023			