

# 004-55004-5 SuterClutch

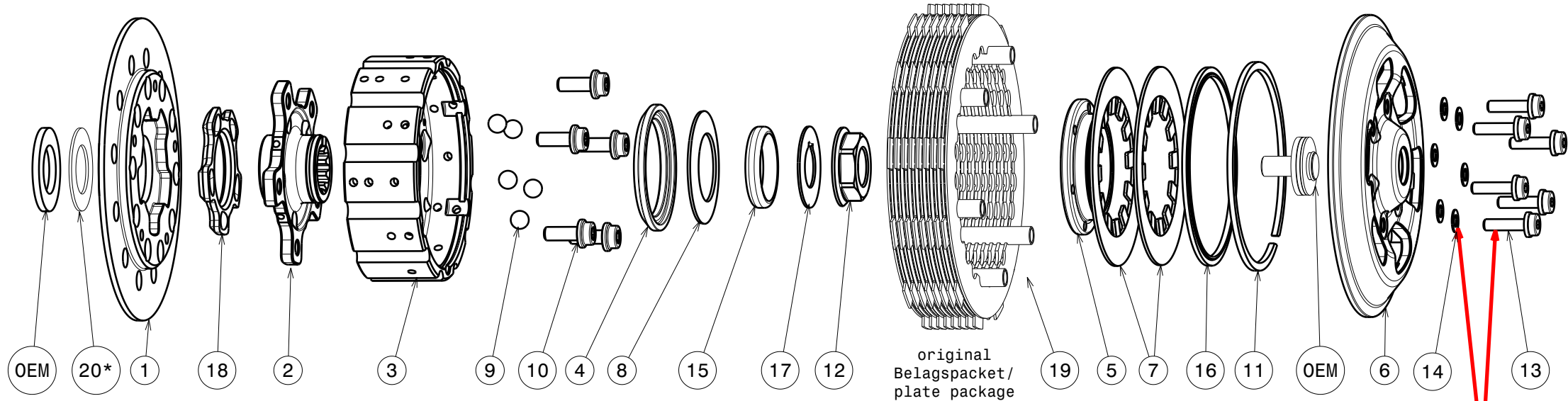

Für Modell For Model	Thrust Washer
250cc 13-14	Pos. 20*
250cc 15-	OEM Washer
350cc	OEM Washer
450cc	Pos. 20*
500/501/510cc	Pos. 20*

In jedem Einbaufall: nur **eine** Scheibe verwenden!  
In any case: use only **one** of the 2 washers!

-Die Scheibe Nr.17 biegen um die Mutter zu sichern!  
-Bend the washer No.17 to lock the nut!

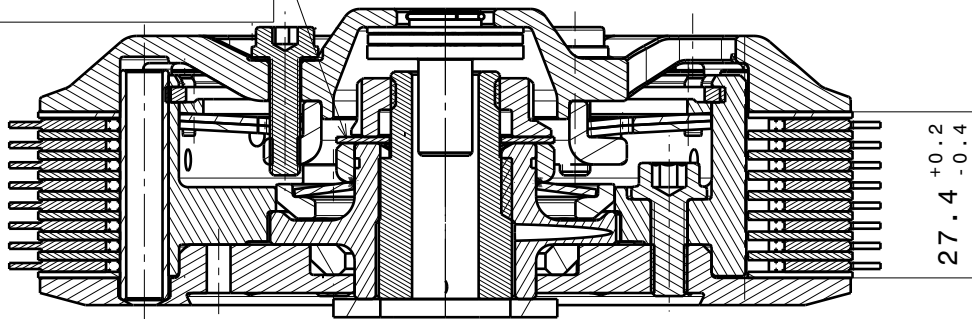

Das angegebene Paketmass ist zwingend einzuhalten!  
The plate package thickness must be strictly adhered to!

**ONLY USE SUTER PARTS**

Partlist: 1887			
ITEM	PART NAME	SRT NUMBER	QTY
1	Back Plate Insert	004-55727	1
2	Hub Carrier	004-55702	1
3	Inner Hub	004-55740	1
4	Release Ring	004-09975	1
5	Clamp Hub 6mm	004-00506	1
6	Pressure plate	004-55940	1
7	<b>Disk Spring Main ø88 700N</b>	<b>004-88070</b>	<b>2</b>
8	<b>Torque Limiter Spring 1100N</b>	<b>004-50110</b>	<b>1</b>
	Torque Limiter Spring 950N	004-50095	1
9	Ball 8mm	004-17801	5
10	Bolt M6x16	004-17816	5
11	Circlip 90mm	004-17804	1
12	Main Nut M18x1.5	004-55958	1
13	Distance Bolt M5 L=19.5mm	004-05195	6
14	Distance Washer 0.5mm	004-00005	6
15	Distance Ring 6.5mm	004-55610	1
16	Locking Ring 88mm	004-00688	1
17	Locking Washer 18/36/1	004-55671	1
18	<b>Ramp Insert 27.5°</b>	<b>004-00721</b>	<b>1</b>
19	Sleeve 38mm	004-55990	6
20	Thrust Washer	004-55901	1

Husaberg		Husqvarna									KTM									
450 FE FC	501 FE FC	250 FE	250 FC	250 TE/TC	300 TE/TC	350 FE	350 FC	450 FS	450 FE FC FX	501 FE	250 SX-F	250 EXC-F	250 SX/EXC/XC-W	300 EXC/XC/XC-W	350 SX-F	350 EXC-F	450 SX-F EXC	450 SMR	500 EXC	
2013-2015	2013-2015	2014-2019	2014-2015	2017-2021	2017-2021	2014-2019	2014-2015	2015-2021	2014-2021	2014-2021	2013-2015	2013-2021	2017-2021	2017-2021	2010-2015	2012-2021	2012-2021	2013-2014	2021	2012-2021