

# 004-55004-1 SuterClutch

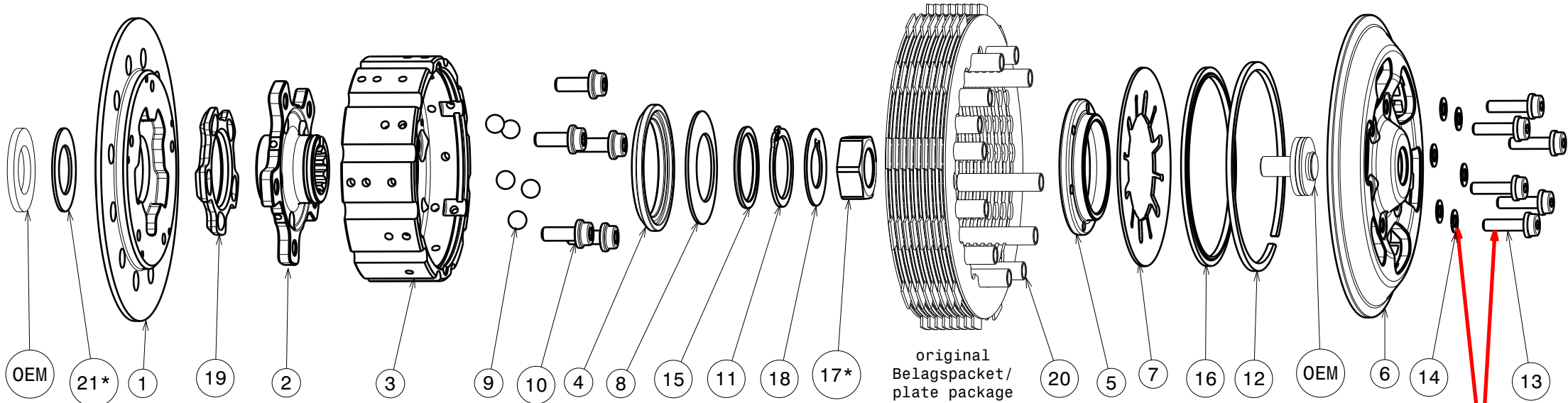

Für Modell For Model	Thrust Washer
250cc 13-14	Pos. 21*
250cc 15-	OEM Washer
350cc	OEM Washer
450cc	Pos. 21*
500/501/510cc	Pos. 21*

In jedem Einbaufall: nur **eine** Scheibe verwenden!  
In any case: use only **one** of the 2 washers!

-Die Scheibe Nr.18 biegen um die Mutter zu sichern!  
-Bend the washer No.18 to lock the nut!

Für Modell For Model	Main Nut
250cc	Pos. 17*
350cc	Pos. 17*
450cc	OEM Nut
500/501/510cc	OEM Nut

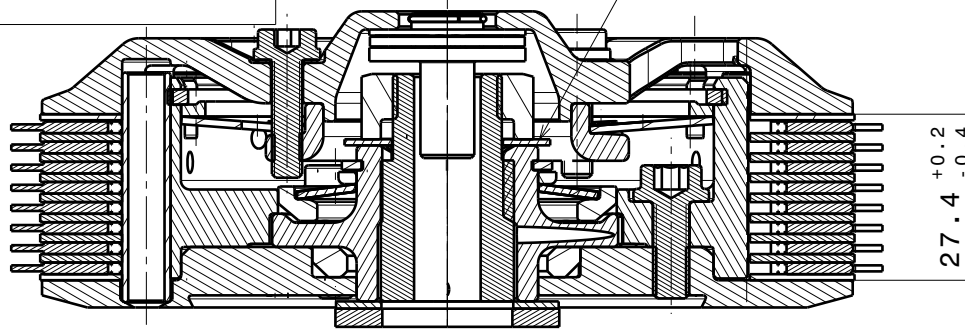

Das angegebene Paketmass ist zwingend einzuhalten!  
The plate package thickness must be strictly adhered to!

**ONLY USE SUTER PARTS**

Partlist: 1887			
ITEM	PART NAME	SRT NUMBER	QTY
1	Back Plate Insert	004-55723	1
2	Hub Carrier	004-55702	1
3	Inner Hub	004-55740	1
4	Release Ring	004-09975	1
5	Clamp Hub 5mm	004-00505	1
6	Pressure plate	004-55940	1
7	<b>Disk Spring Main ø88 1235N</b>	<b>004-88123</b>	<b>1</b>
8	<b>Torque Limiter Spring 950N</b>	<b>004-50095</b>	<b>1</b>
	Torque Limiter Spring 750N MX	004-50075	1
9	Ball 8mm	004-17801	5
10	Bolt M6x16	004-17816	5
11	Circlip 30mm	004-00030	1
12	Circlip 90mm	004-17804	1
13	Distance Bolt M5 L=19.5mm	004-05195	6
14	Distance Washer 0.5mm	004-00005	6
15	Distance Ring 30x36x2	004-17610	1
16	Locking Ring 88mm	004-00688	1
17	Nut M18x1.5	004-55955	1
18	Locking Washer	004-08670	1
19	<b>Ramp Insert 30°</b>	<b>004-00722</b>	<b>1</b>
20	Sleeve 38mm	004-55990	12
21	Thrust Washer	004-55901	1

Husaberg		Husqvarna									KTM									
450 FE FC	501 FE FC	250 FE	250 FC	250 TE/TC	300 TE/TC	350 FE	350 FC	450 FS	450 FE FC	501 FE	250 SX-F	250 EXC-F	250 SX/EXC/XC/XC-W	300 EXC/XC/XC-W	350 SX-F	350 EXC-F	450 SX-F EXC	450 SMR	500 EXC	
2013	2013	2014	2014	2017	2017	2014	2014	2015	2014	2014	2013	2013	2017	2017	2010	2012	2012	2013	2012	
-	-	-	-	-	-	-	-	-	-	-	-	-	-	-	-	-	-	-	-	-
2015	2015	2019	2015	2020	2020	2019	2015	2020	2020	2019	2015	2020	2020	2020	2015	2020	2020	2014	2020	