

004-31053-1 SuterClutch MX-Line EVO

Kawasaki KX250F 21-24

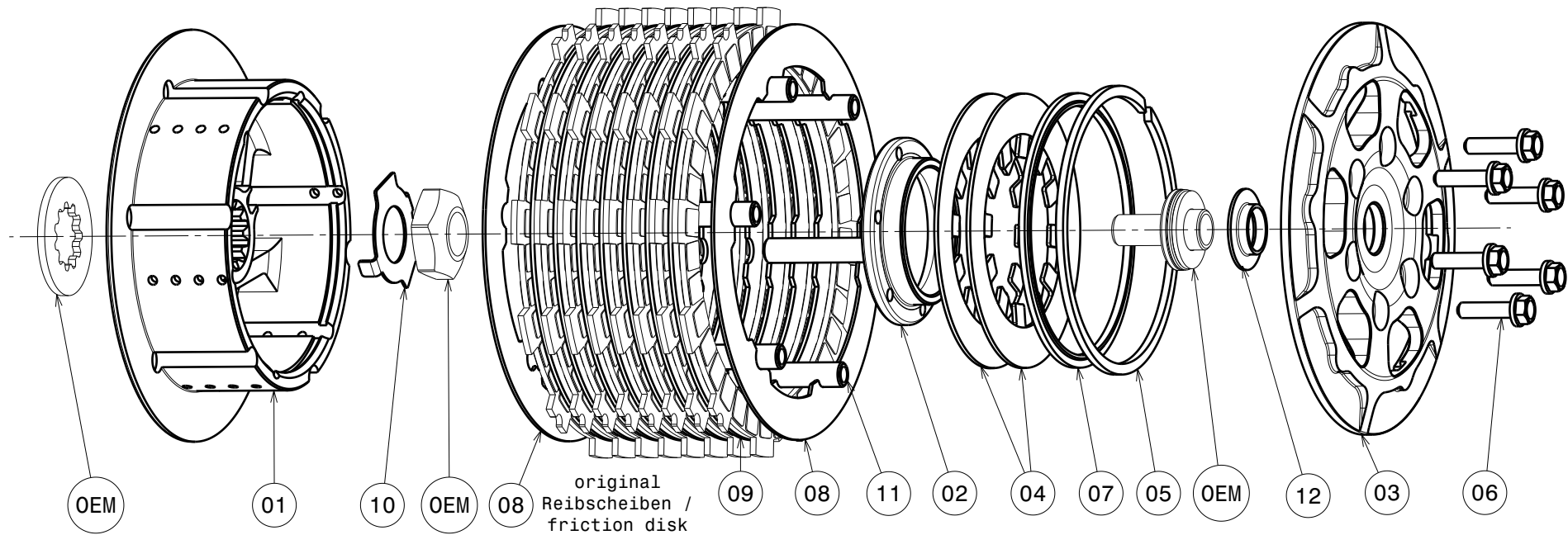

-Die Scheibe Nr.10 biegen um die Mutter zu sichern!
 -Bend the washer No.10 to lock the nut!

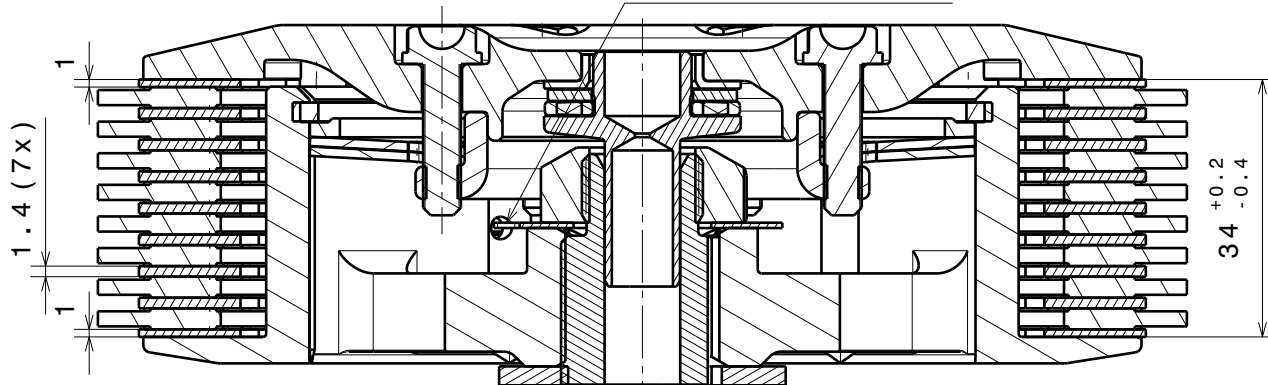

Das angegebene Belagpaketmass ist zwingend einzuhalten!
The platepackage thickness must be strictly adhered to!

ITEM	PART NAME	PART NUMBER	QTY
1	Inner Hub KX250F	004-31741	1
2	Clamp Hub 7mm	004-00507	1
3	Pressure Plate KX250F	004-31944	1
4	Diskspring d=88mm 600N	004-88060	2
5	Circlip 90mm	004-17804	1
6	Bolt M5x20	999-110205020	6
7	Locking Ring 88mm	004-00688	1
8	Steel Disc Type 53 t=1.0	004-996113353100	2
9	Steel Disc Type 53 t=1.4	004-996113353140	7
10	Locking Washer 18x31x0.7	004-00673	1
11	Sleeve 39.3mm	004-26990	6
12	Bush Pressure Plate	004-10950	1