

004-26055-4 SuterClutch MX-Line

Yamaha YZ250 2000-2023 FACTORY

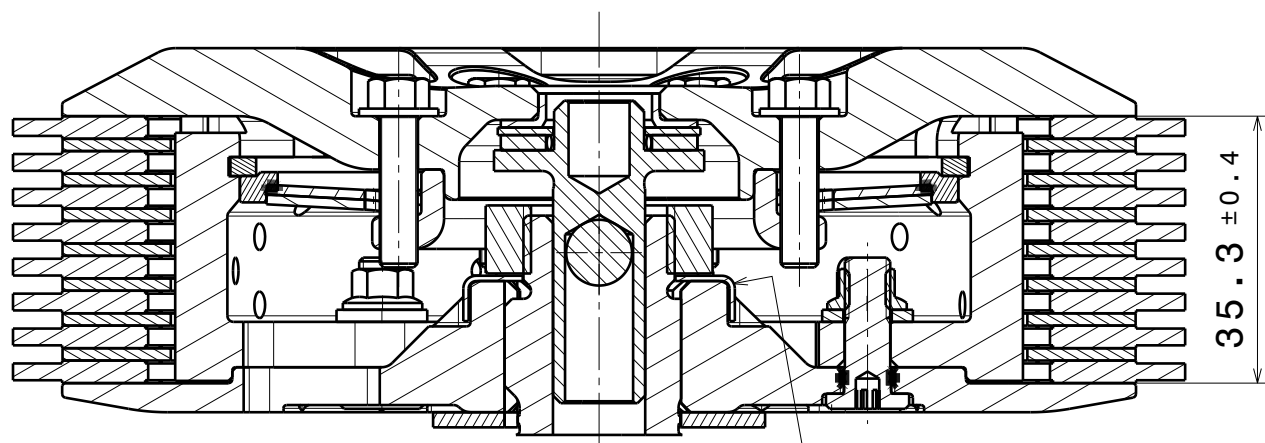
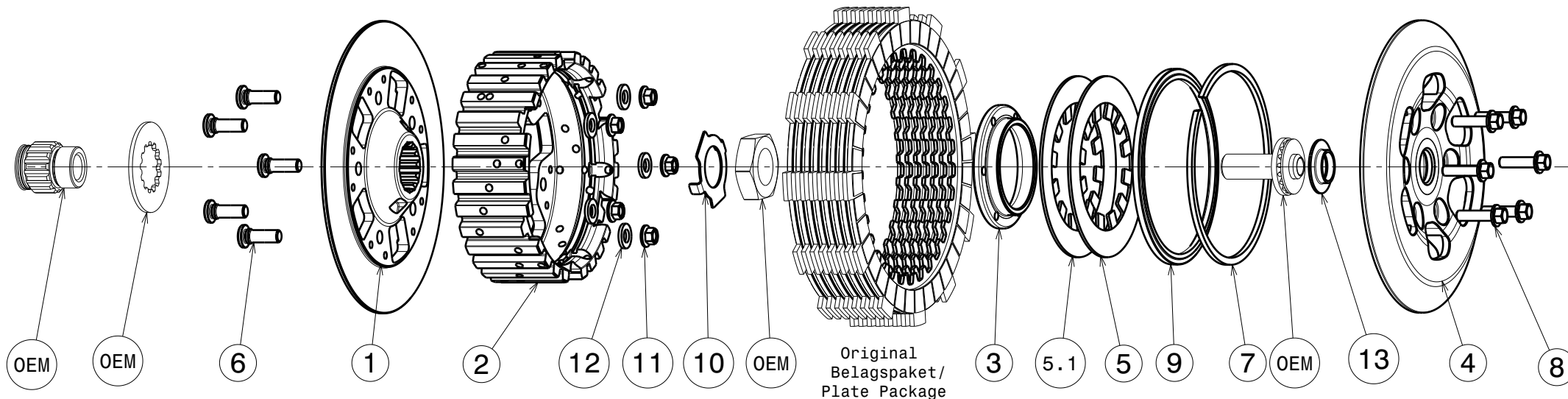

-Die Scheibe Nr.10 biegen um die Mutter zu sichern!
-Bend the washer No.10 to lock the nut!

ITEM	PART NAME	SRT NUMBER	QTY
1	BACK PLATE PD	004-26729	1
2	INNER HUB	004-26742	1
3	CLAMP HUB 6mm	004-00506	1
4	PRESSURE PLATE	004-26947	1
5	Disk Spring Main ø88 700N	004-88070	1
5.1	Disk Spring Main ø88 600N	004-88060	1
6	STUDS M6 L=18mm	004-12981	5
7	CIRCLIP 95mm	004-17813	1
8	Hex. Head Bolt M5x20 Titan	999-112205020	6
9	LOCKING RING 95mm	004-00695	1
10	LOCKING WASHER 20/31/0.7mm MX	004-00672	1
11	NUT M6	999-12030605	5
12	WASHER M6	BN1976-6x12x1.0	5
13	SPACER 1.0mm	004-10950	1

-Das angegebene Belagspaketmass ist zwingend einzuhalten!

Einstellmöglichkeiten: Stahlscheibe (2.00mm) 5VY-16325-00

Stahlscheibe (1.16mm) 5JG-16325-00

-The plate package thickness must be strictly adhered to!

Adjustment possibility: Steelplate (2.00mm) 5VY-16325-00

Steelplate (1.16mm) 5JG-16325-00