

004-26052-2 SuterClutch MX-Line Yamaha YZ450F 2023

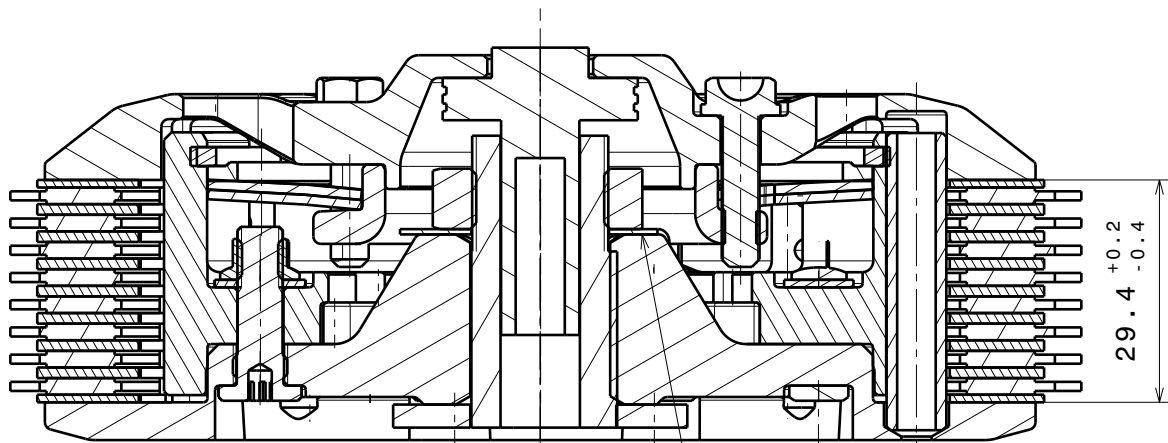
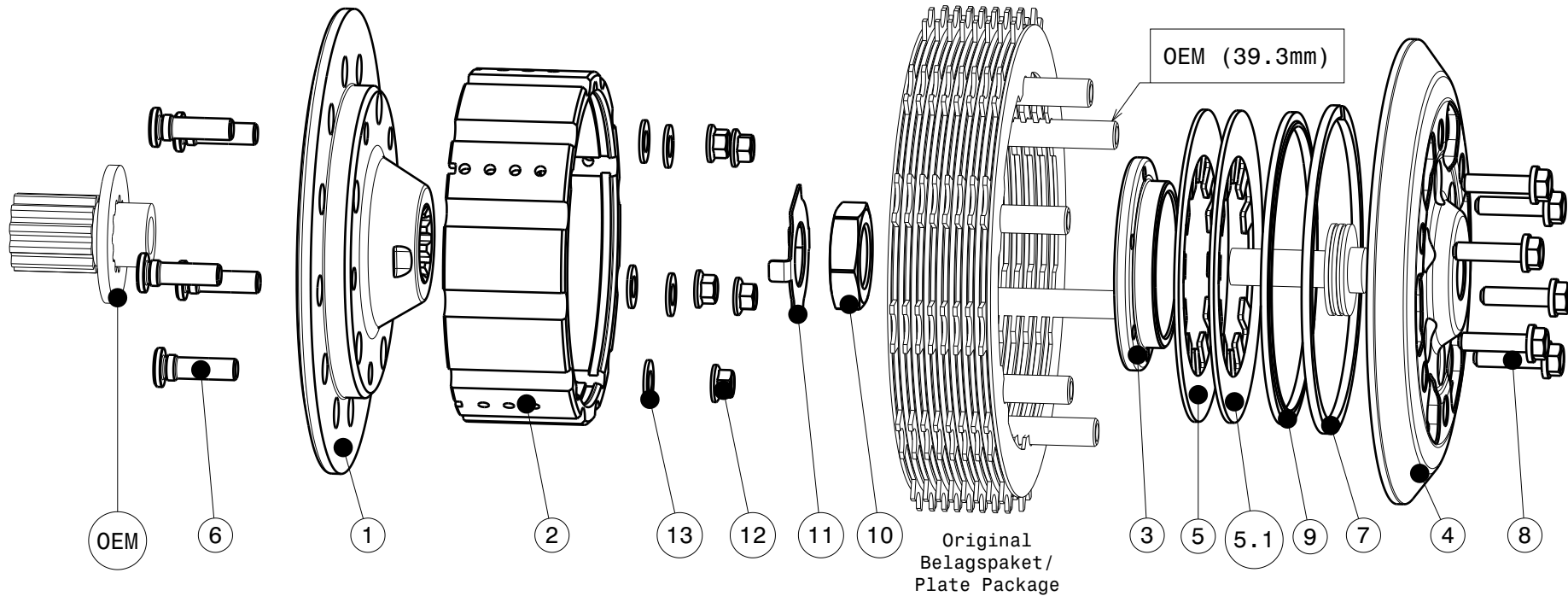

-Die Scheibe Pos.11 biegen um die Mutter zu sichern!
-Bend the washer No.11 to lock the nut!

| ITEM | PART NAME | PART NUMBER | QTY |
|------|----------------------------------|------------------|----------|
| 1 | Back Plate PD YZ450F 2023 | 004-26732 | 1 |
| 2 | Inner Hub YZ450F | 004-26743 | 1 |
| 3 | Clamp Hub 6mm | 004-00506 | 1 |
| 4 | Pressure Plate | 004-26949 | 1 |
| 5 | Disk Spring Main ø88 700N | 004-88070 | 1 |
| 5.1 | Disk Spring Main ø88 800N | 004-88080 | 1 |
| 6 | Stud Moto2 Backplate | 004-12980 | 5 |
| 7 | Circlip 90mm | 004-17804 | 1 |
| 8 | Hex. Head Bolt M5x20 | 999-11025020 | 6 |
| 9 | Locking Ring 88mm | 004-00688 | 1 |
| 10 | Nut M18x1 | 004-998181080 | 1 |
| 11 | Locking Washer 18x31x0.7 | 004-00673 | 1 |
| 12 | Flanged Nut self-locking M6 | 999-12030605 | 5 |
| 13 | Washer M6 | BN1976-6x12x1 | 5 |

Das angegebene Belagspaketmass ist zwingend einzuhalten!
The plate package thickness must be strictly adhered to!