

004-26051-2 SuterClutch MX-Line

Yamaha / Fantic 450 FACTORY

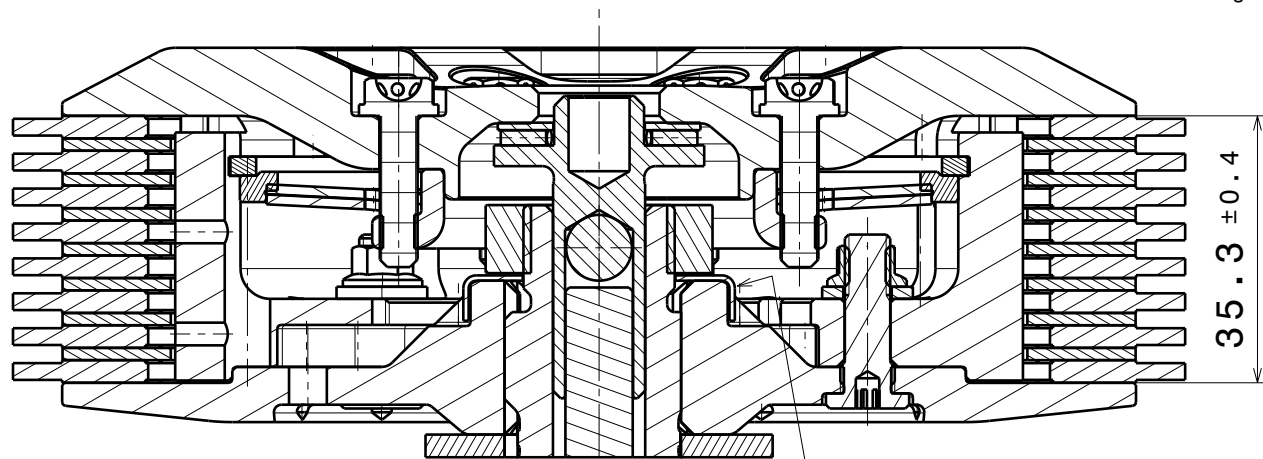
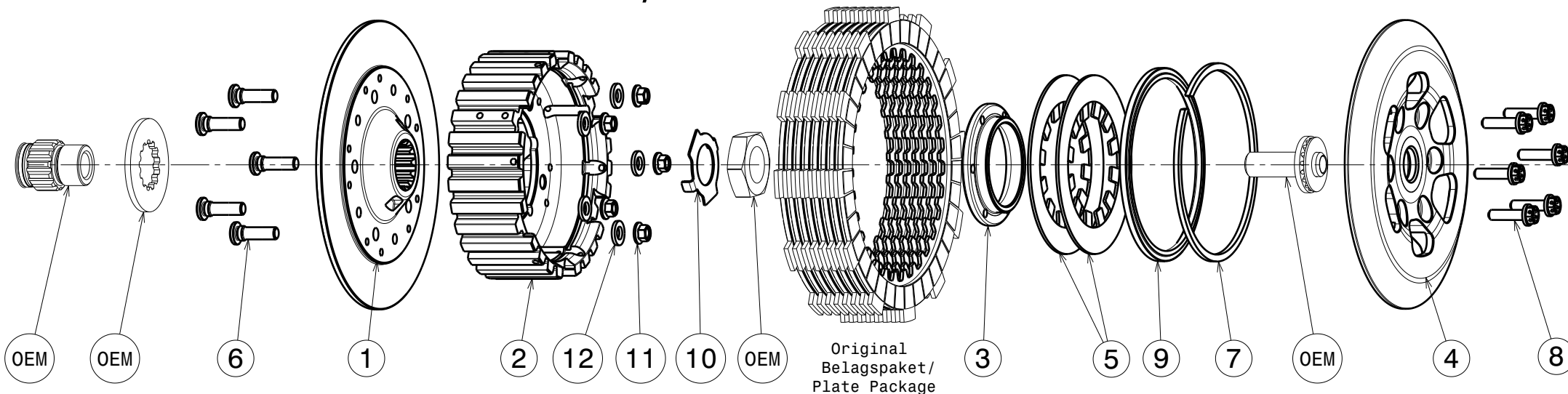

-Die Scheibe Nr.10 biegen um die Mutter zu sichern!
-Bend the washer No.10 to lock the nut!

ITEMS LIST (1448)			
ITEM	PART NAME	SRT NUMBER	QTY
1	BACK PLATE PD	004-26728	1
2	INNER HUB	004-33741	1
3	CLAMP HUB 6mm	004-00506	1
4	PRESSURE PLATE	004-26946	1
5	Disk Spring Main ø88 800N	004-88080	2
6	STUDS M6	004-12980	5
7	CIRCLIP 95mm	004-17813	1
8	Hex. Head Bolt M5x20 Titan	999-112205020	6
9	LOCKING RING 95mm	004-00695	1
10	LOCKING WASHER 20/31/0.7mm MX	004-00672	1
11	NUT M6	999-12030605	5
12	WASHER M6	BN1976-6x12x1.0	5

Das angegebene Belagspaketmass ist zwingend einzuhalten!
The plate package thickness must be strictly adhered to!

	Fantic	Yamaha	
	XXF 450	YZ450F	WR450F
	2022	2007 - 2022	2007 - 2022