

# 004-26050-5 SuterClutch MX-Line Yamaha / Fantic 450

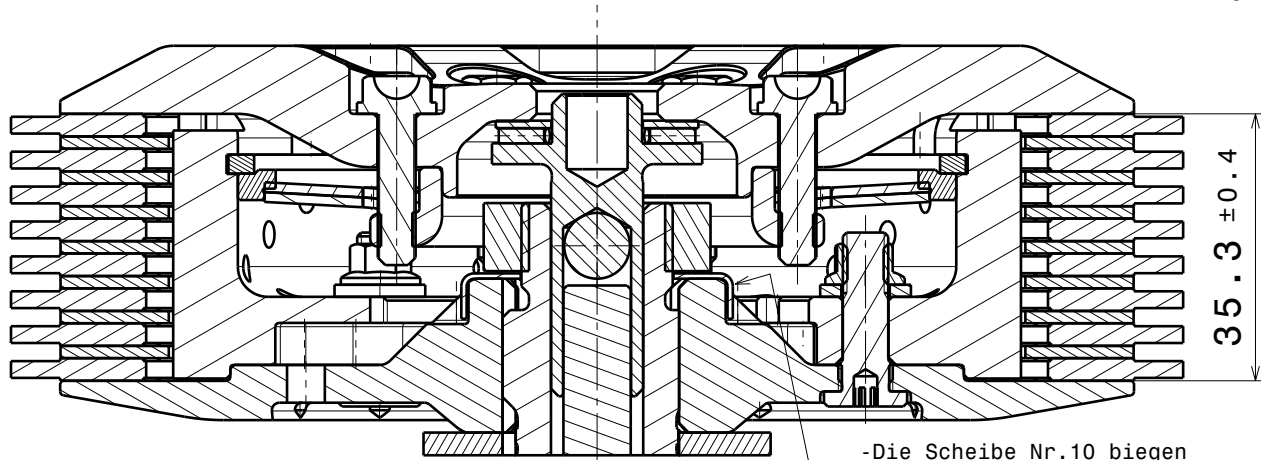
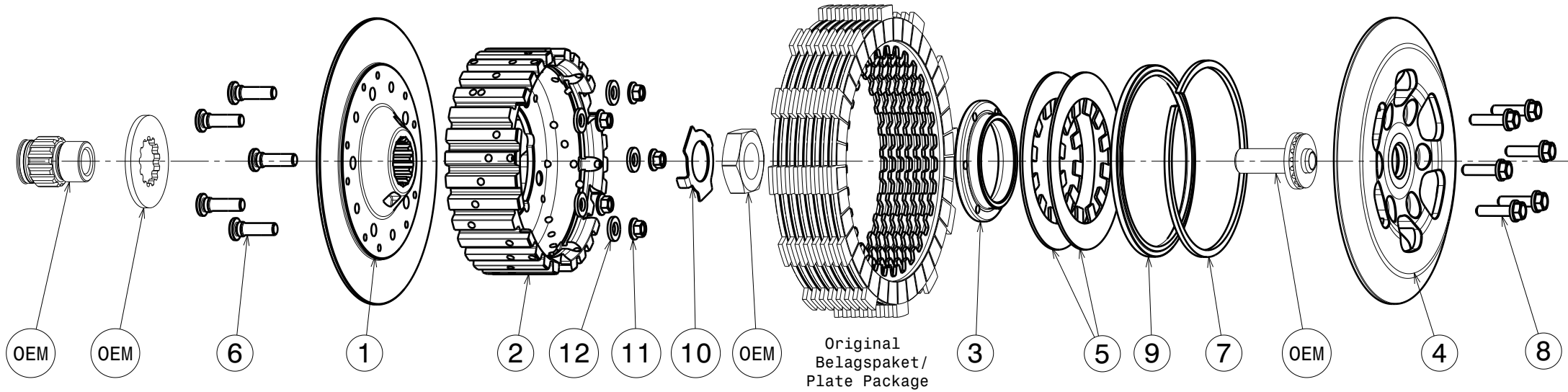

-Die Scheibe Nr.10 biegen um die Mutter zu sichern!  
-Bend the washer No.10 to lock the nut!

**Das angegebene Belagspaketmass ist zwingend einzuhalten!**  
**The plate package thickness must be strictly adhered to!**

ITEMS LIST (1448)			
ITEM	PART NAME	SRT NUMBER	QTY
1	BACK PLATE PD	004-26725	1
2	INNER HUB	004-33741	1
3	CLAMP HUB 6mm	004-00506	1
4	PRESSURE PLATE	004-26945	1
5	<b>Disk Spring Main ø88 700N</b>	<b>004-88070</b>	<b>2</b>
6	STUDS M6	004-12980	5
7	CIRCLIP 95mm	004-17813	1
8	Bolt M5x20	999-110205020	6
9	LOCKING RING 95mm	004-00695	1
10	LOCKING WASHER 20/31/0.7mm MX	004-00672	1
11	NUT M6	999-12030605	5
12	WASHER M6	BN1976-6x12x1.0	5

	Fantic	Yamaha	
	XXF 450	YZ450F	WR450F
	2022	2007 - 2022	2007 - 2022