

004-22053-0 SuterClutch MX-Line EVO

Yamaha/Fantic 250/300 4T

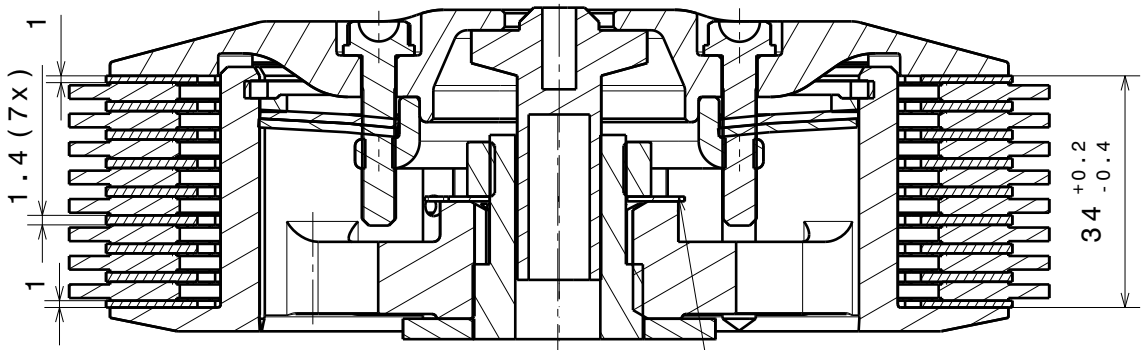
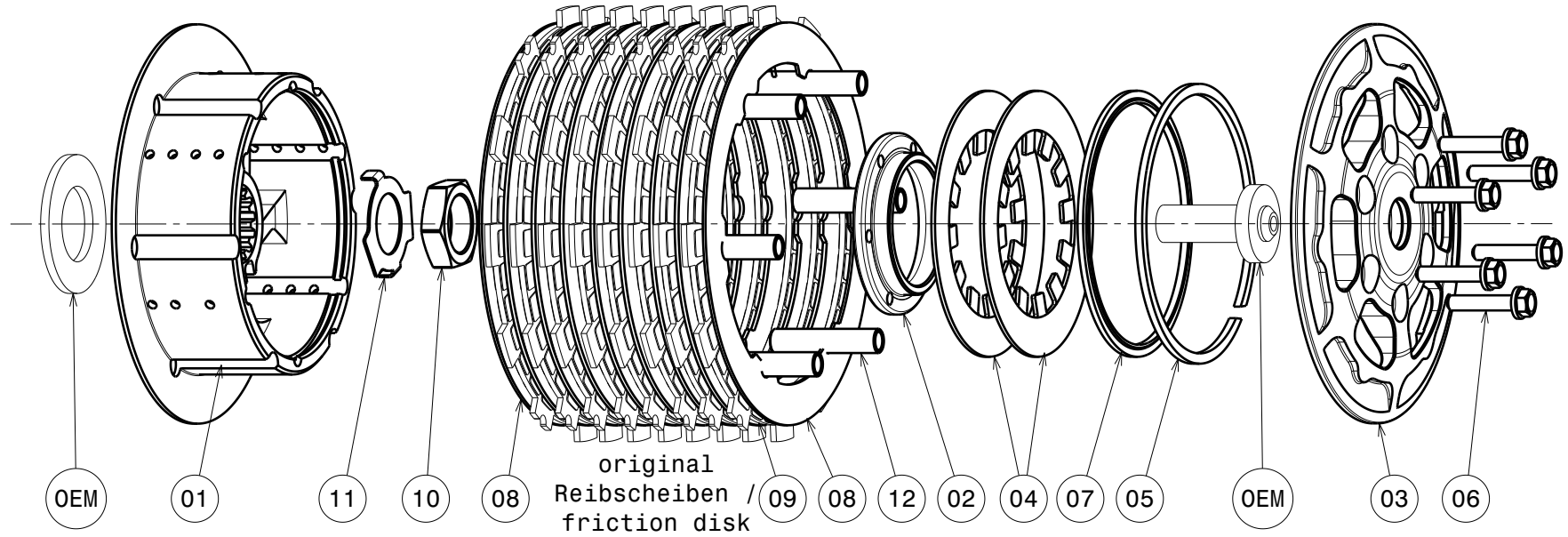

-Die Scheibe Nr.11 biegen um die Mutter zu sichern!
 -Bend the washer No.11 to lock the nut!

ITEM	PART NAME	PART NUMBER	QTY
1	Inner Hub YZ250F	004-22743	1
2	Clamp Hub 6mm	004-00506	1
3	Pressure Plate YZ250F	004-22950	1
4	Diskspring d=88mm 700N	004-88070	2
5	Circlip 90mm	004-17804	1
6	Bolt M5x25	999-110205025	6
7	Locking Ring 88mm	004-00688	1
8	Steel Disc Type 53 t=1.0	004-996113353100	2
9	Steel Disc Type 53 t=1.4	004-996113353140	7
10	Nut M20x1	004-998201080	1
11	Locking Washer 20x31x0.7	004-00672	1
12	Sleeve 38mm	004-55990	6

Fantic			Yamaha	
XXF 250	XEF 250	XEF 310	YZ250F	WR250F
	2022		2019	2020
	2024	2024	- 2024	- 2024

Das angegebene Paketmass ist zwingend einzuhalten!
The plate package thickness must be strictly adhered to!