

004-22003-1 SuterClutch Yamaha

YZ250F 01-18
WR250F 01-19

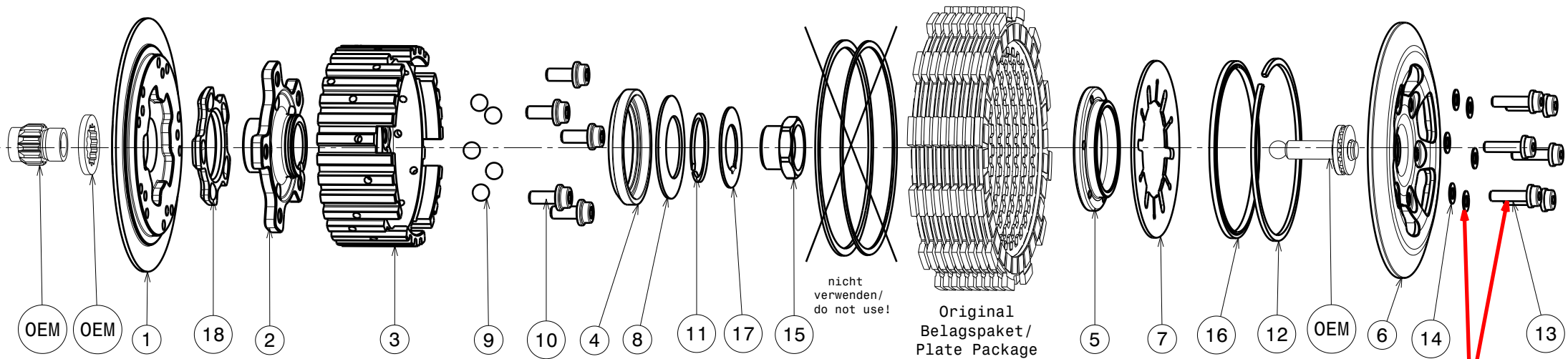

ONLY USE SUTER PARTS

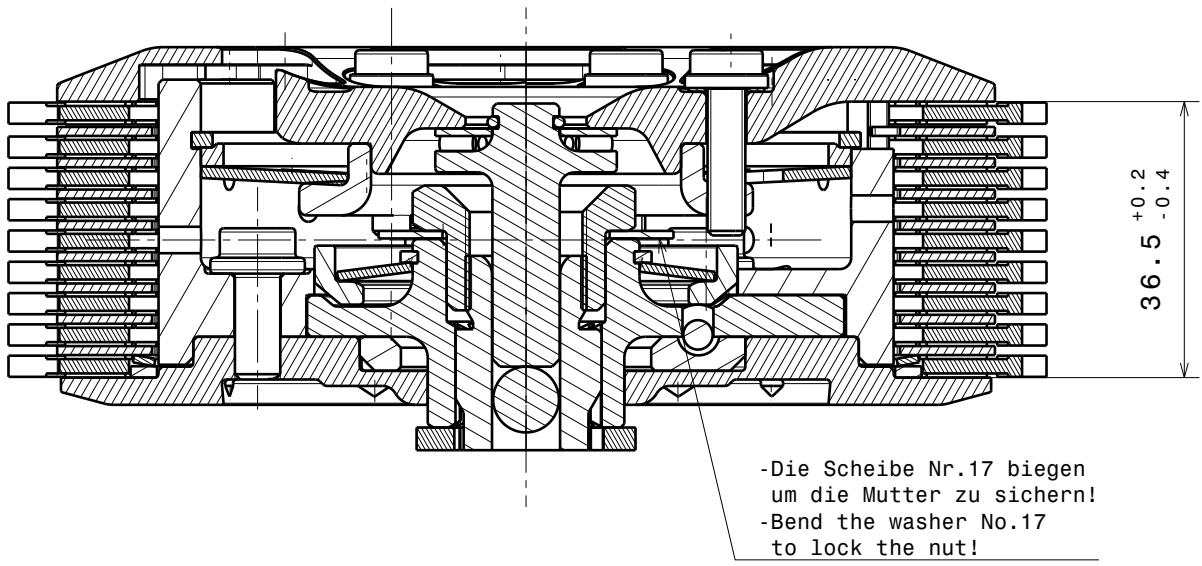

**Das angegebene Belagspaketmass ist zwingend einzuhalten!
The plate package thickness must be strictly adhered to!**

| Partlist: 1898 | | | |
|----------------|------------------------------------|------------------|----------|
| ITEM | PART NAME | SRT NUMBER | QTY |
| 1 | Back Plate Insert | 004-22723 | 1 |
| 2 | Hub Carrier | 004-22700 | 1 |
| 3 | Inner Hub | 004-22740 | 1 |
| 4 | Release Ring | 004-15975 | 1 |
| 5 | Clamp Hub 5mm | 004-00505 | 1 |
| 6 | Pressure Plate | 004-22940 | 1 |
| 7 | Disk Spring Main ø86 1000N | 004-86100 | 1 |
| 8 | Torque Limiter Spring 1300N | 004-50130 | 1 |
| | Torque Limiter Spring 600N MX | 004-50060 | 1 |
| 9 | Ball 8mm | 004-17801 | 5 |
| 10 | Bolt M6x14 | 004-17814 | 5 |
| 11 | Circlip 30mm | 004-17803 | 1 |
| 12 | Circlip 86mm | 004-17886 | 1 |
| 13 | Distance Bolt M5 L=19.5mm | 004-05195 | 6 |
| 14 | Distance Washer 0.5mm | 004-00005 | 6 |
| 15 | Nut M16x1 | 004-22955 | 1 |
| 16 | Locking Ring 86mm | 004-00686 | 1 |
| 17 | Locking Washer | 004-07670 | 1 |
| 18 | Ramp Insert 30° H=4.5mm | 004-00742 | 1 |