

004-05002-3 SuterClutch KTM 1050-1390

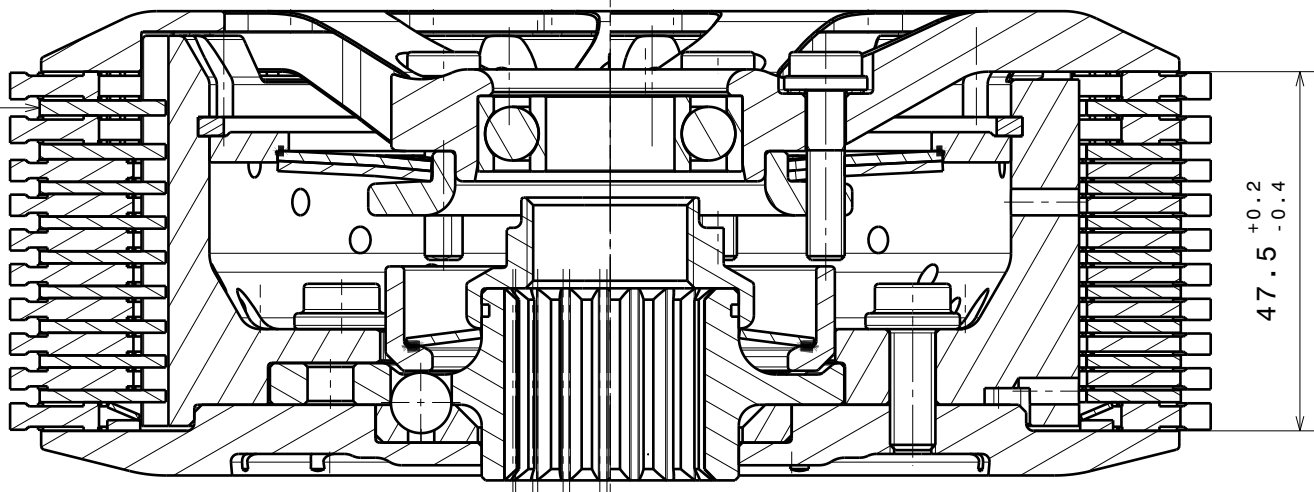
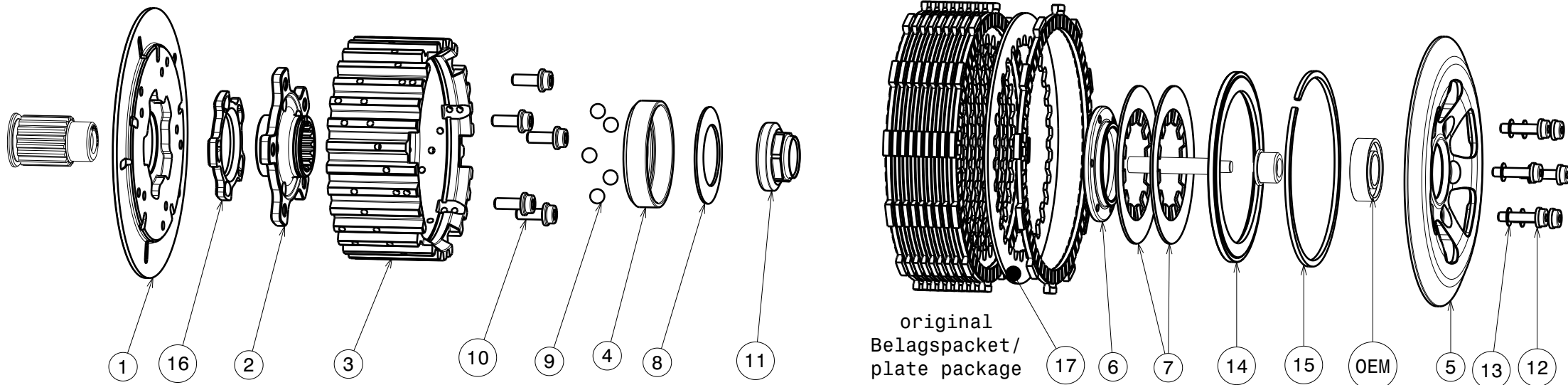

Diese Stahlscheibe muss durch die mitgelieferte (Pos.17) ersetzt werden
 This steel disk has to be replaced with the delivered one (Pos.17)

Das angegebene Belagspaketmass ist zwingend einzuhalten!
The plate package thickness must be strictly adhered to!

| ITEM | PART NAME | SRT NUMBER | QTY |
|------|------------------------------------|------------------|----------|
| 1 | Back Plate | 004-05721 | 1 |
| 2 | Hub Carrier | 004-07700 | 1 |
| 3 | Inner Hub | 004-05740 | 1 |
| 4 | Release Ring | 004-36975 | 1 |
| 5 | Pressure Plate | 004-05941 | 1 |
| 6 | Clamp Hub ø64 4mm | 004-00524 | 1 |
| 7 | Disk Spring Main ø88 800N | 004-88080 | 2 |
| 7* | Disk Spring Main ø88 900N | 004-88090 | 1 |
| | Torque Limiter Spring 1300N | 004-54130 | 1 |
| 8 | Torque Limiter Spring 1100N | 004-54110 | 1 |
| | Torque Limiter Spring 1500N | 004-54150 | 1 |
| 9 | Ball 8mm | 004-17801 | 5 |
| 10 | Bolt M6x16 | 004-17816 | 5 |
| 11 | Main Nut M22x1.5 L=5.3 | 004-999221553 | 1 |
| 12 | Distance Bolt M5 L=22.5mm | 004-05225 | 6 |
| 13 | Distance Washer 0.5mm | 004-00005 | 6 |
| 14 | Locking Ring 106mm | 004-00606 | 1 |
| 15 | Circlip 107 | 004-17831 | 1 |
| 16 | Ramp Insert 35° | 004-11712 | 1 |
| 17 | Steel Disc 2.0mm | 004-05920 | 1 |

| Model | 1390 SuperDuke R | 1290 Super ADV (S,R,T) | 1290 Super Duke (R,GT) | 1190 Adventure (R) | 1190 RC8 R | 1090 Adventure (R,L) | 1050 Adventure |
|-------|------------------------|------------------------------|------------------------------|--------------------------|---------------|----------------------------|-------------------|
| Year | 2024 | 2015-2023 | 2014-2023 | 2013-2016 | 2013-2014 | 2017-2019 | 2015-2016 |

Für die 1390-Modelle ist die Hauptfeder 7* (900N) **zusammen** mit **einer** 800N Hauptfeder einzubauen
 Install main spring 7* (900N) **together with one** 800N main spring on the 1390-models